

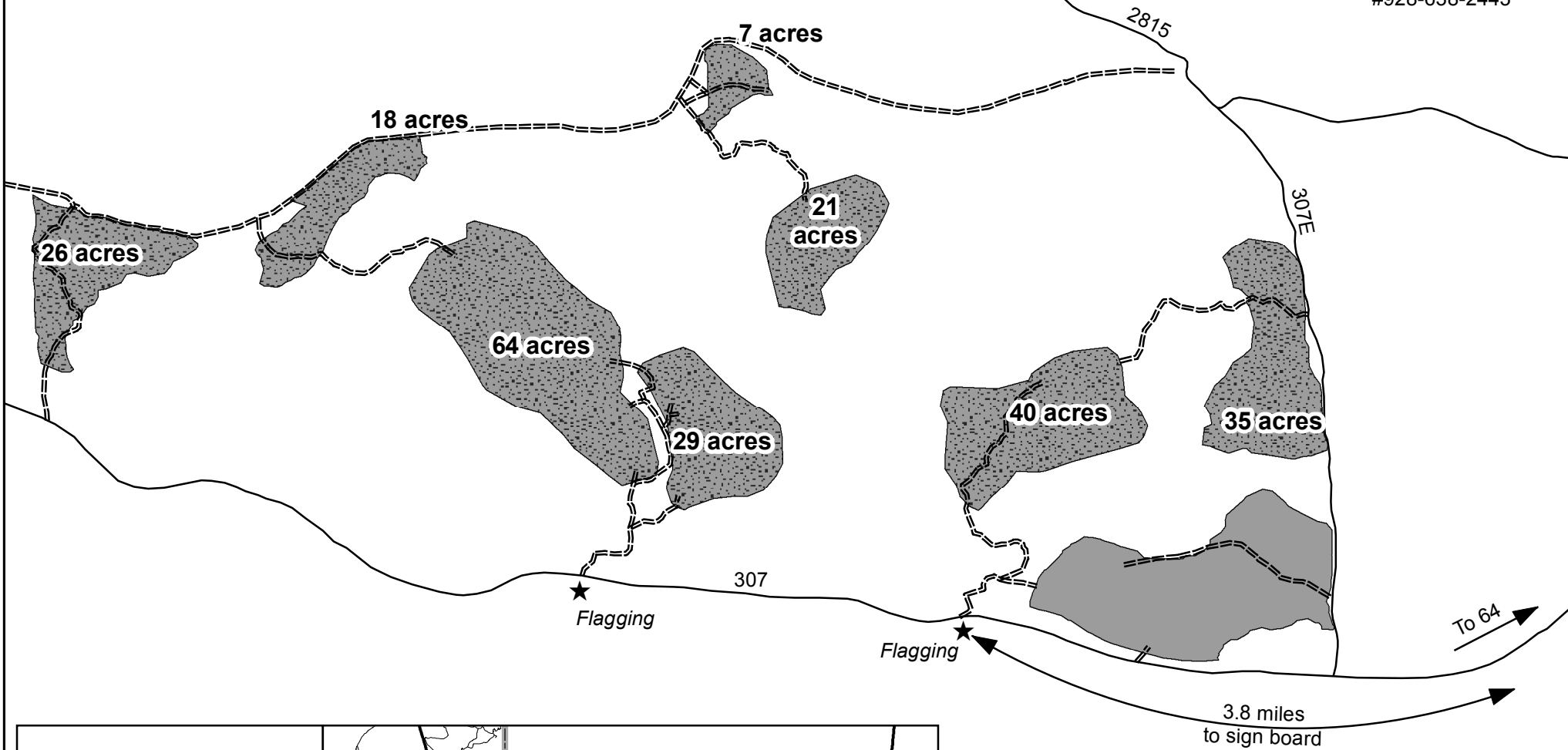



Free Use Permit Areas

Tusayan Office
#928-638-2443



Legend

-  Access Roads with Permit
-  Open Roads
-  Concentration of Cut Trees
-  Free Use Area

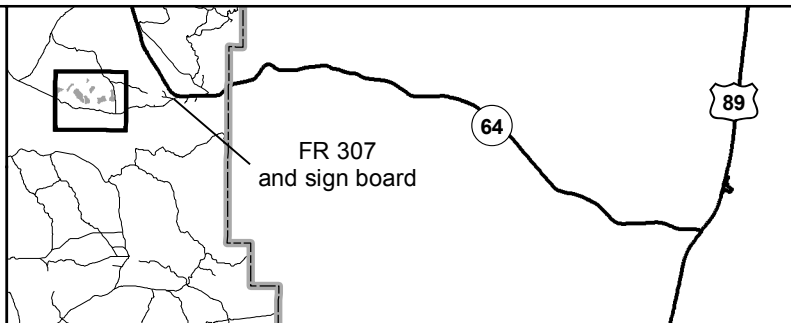

Notes:

- From the turn off Route 89, it is approximately 20 miles on Highway 64 to the turn onto FR 307. There is a signboard just off Highway 64 at the turn.
- Cross country travel within shaded areas and on access roads is authorized.

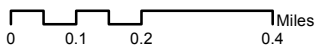

This product is reproduced from geospatial information prepared by the Kaibab National Forest. Geospatial information and GIS product accuracy may vary. Using GIS products for purposes other than those for which they were created may yield inaccurate or misleading results. Kaibab National Forest reserves the right to correct, update, modify or replace GIS products without notification.